

# 鹤山市共和镇平汉村国庆股份经济合作社征收土地红线图

2499.965-38393.692

单位: m.m<sup>2</sup>

8393.69
8394.26

2500.75
2500.75

界址点坐标表

点号	X	Y	边长	点号	X	Y	边长
J1	2500569.501	38394202.641	0.82	J19	2500513.961	38394230.989	0.01
J2	2500568.715	38394202.865	1.36	J19	2500513.954	38394230.985	0.33
J3	2500567.471	38394203.408	1.29	J20	2500513.651	38394230.844	1.15
J4	2500566.291	38394203.923	1.67	J21	2500512.614	38394230.359	3.33
J5	2500564.762	38394204.590	1.13	J22	2500509.600	38394228.952	0.23
J6	2500563.726	38394205.041	7.55	J23	2500509.392	38394228.855	1.01
J7	2500566.808	38394208.059	5.45	J25	2500508.477	38394228.429	0.00
J8	2500551.992	38394210.604	11.12	J25	2500508.475	38394228.428	1.69
J9	2500542.157	38394215.802	13.01	J26	2500506.940	38394227.713	0.22
J10	2500530.776	38394222.098	0.66	J27	2500506.742	38394227.621	0.11
J11	2500530.201	38394222.416	10.48	J28	2500506.646	38394227.576	0.15
J12	2500520.891	38394227.218	7.19	J29	2500506.509	38394227.512	4.24
J13	2500515.150	38394231.546	0.30	J30	2500502.661	38394225.731	0.62
J14	2500514.880	38394231.419	0.04	J31	2500502.102	38394225.472	1.65
J15	2500514.845	38394231.402	0.01	J32	2500500.604	38394224.779	2.36
J16	2500514.835	38394231.397	0.96	J33	2500498.459	38394223.786	0.07
J18	2500513.967	38394230.991	0.01	J34	2500498.396	38394223.757	1.01
J19	2500513.961	38394230.989		J35	2500497.478	38394223.334	

点号	X	Y	边长	点号	X	Y	边长
J35	2500497.478	38394223.334	10.11	J53	2500454.567	38394204.038	0.00
J36	2500488.290	38394219.123	1.01	J53	2500454.563	38394204.037	0.50
J37	2500487.370	38394218.704	3.03	J54	2500454.106	38394203.836	1.01
J38	2500484.609	38394217.448	3.03	J55	2500453.178	38394203.430	6.82
J39	2500481.846	38394216.195	1.01	J56	2500446.923	38394200.713	3.27
J40	2500480.925	38394215.778	0.17	J57	2500443.924	38394199.410	1.82
J41	2500480.773	38394215.709	1.45	J58	2500442.310	38394198.579	2.45
J42	2500479.512	38394214.995	0.16	J59	2500440.031	38394197.689	5.24
J43	2500479.377	38394214.919	3.40	J60	2500435.147	38394195.783	0.26
J44	2500476.252	38394213.575	5.77	J61	2500434.908	38394195.691	0.17
J45	2500470.949	38394211.293	1.20	J62	2500434.750	38394195.629	9.40
J46	2500469.851	38394210.800	8.10	J63	2500429.990	38394187.519	6.41
J47	2500462.450	38394207.509	2.03	J64	2500425.594	38394182.859	5.57
J48	2500460.597	38394206.691	1.87	J65	2500421.769	38394178.804	9.89
J49	2500458.884	38394205.936	3.01	J66	2500415.199	38394171.418	6.77
J50	2500456.211	38394204.559	0.51	J67	2500411.702	38394165.626	8.67
J51	2500455.728	38394204.406	1.22	J68	2500410.937	38394156.992	11.48
J53	2500454.567	38394204.038		J69	2500410.610	38394145.516	

点号	X	Y	边长
J69	2500410.610	38394145.516	17.57
J70	2500409.072	38394128.016	9.75
J71	2500406.975	38394118.496	3.53
J72	2500406.235	38394115.042	4.70
J73	2500408.578	38394110.970	5.58
J74	2500406.851	38394105.665	14.49
J75	2500396.985	38394095.055	13.88
J76	2500388.234	38394084.281	11.62
J77	2500379.727	38394076.358	27.04
J78	2500358.948	38394059.059	11.04
J79	2500351.032	38394051.361	11.03
J80	2500343.988	38394042.870	12.47
J81	2500338.544	38394031.656	4.40
J82	2500335.569	38394028.417	6.67
J83	2500332.944	38394022.290	1.03
J84	2500332.670	38394021.297	4.24
J85	2500331.544	38394017.212	5.57
J86	2500328.218	38394012.748	

点号	X	Y	边长	点号	X	Y	边长
J86	2500328.218	38394012.748	6.46	J103	2500299.227	38393962.073	6.76
J87	2500322.443	38394009.859	1.33	J104	2500297.131	38393968.502	8.02
J88	2500321.212	38394009.344	5.69	J105	2500295.959	38393976.431	6.31
J89	2500315.967	38394007.146	6.75	J106	2500297.573	38393982.531	11.05
J90	2500311.154	38394002.419	13.38	J107	2500305.806	38393989.900	5.09
J91	2500302.537	38393992.177	18.34	J108	2500309.600	38393993.286	20.53
J92	2500290.848	38393978.051	13.15	J109	2500325.809	38394005.880	20.40
J93	2500281.958	38393968.367	7.57	J110	2500342.056	38394018.214	10.02
J94	2500277.716	38393962.098	0.77	J111	2500349.867	38394024.499	8.94
J95	2500278.480	38393962.075	3.92	J112	2500356.834	38394030.106	4.02
J96	2500282.396	38393961.956	9.26	J113	2500360.021	38394032.559	3.76
J97	2500291.652	38393961.676	11.79	J114	2500363.000	38394034.858	13.68
J98	2500302.027	38393956.067	0.60	J115	2500373.818	38394043.236	15.59
J99	2500302.559	38393955.779	3.19	J116	2500386.152	38394052.767	4.45
J100	2500305.594	38393954.803	1.88	J117	2500389.675	38394055.491	14.43
J101	2500306.999	38393956.057	0.28	J118	2500401.178	38394064.205	5.58
J102	2500306.729	38393956.148	9.56	J119	2500405.544	38394067.673	20.00
J103	2500299.227	38393962.073		J120	2500421.174	38394080.155	

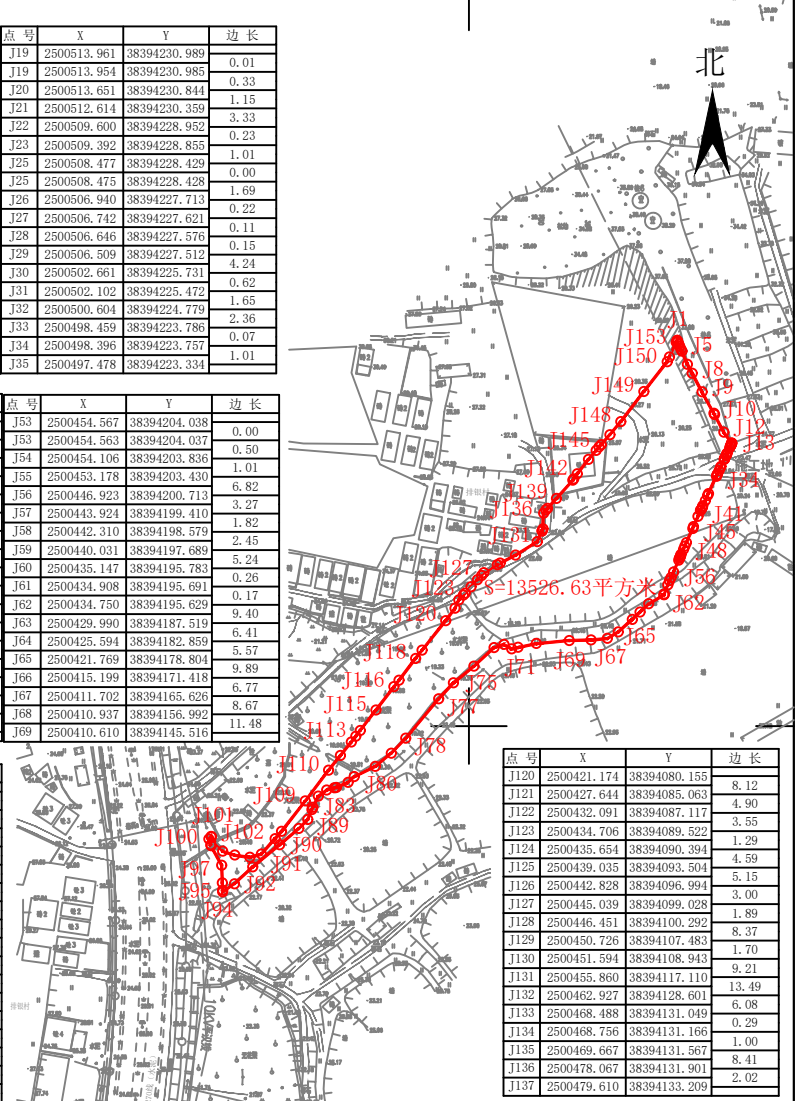

点号	X	Y	边长
J120	2500421.174	38394080.155	8.12
J121	2500427.644	38394085.063	4.90
J122	2500432.091	38394087.117	3.55
J123	2500434.706	38394089.522	1.29
J124	2500435.654	38394090.394	4.59
J125	2500439.035	38394093.504	5.15
J126	2500442.828	38394096.994	3.00
J127	2500445.039	38394099.028	1.89
J128	2500446.451	38394100.292	8.37
J129	2500450.726	38394107.483	1.70
J130	2500451.594	38394108.943	9.21
J131	2500455.860	38394117.110	13.49
J132	2500462.927	38394128.601	6.08
J133	2500468.488	38394131.049	0.29
J134	2500468.756	38394131.166	1.00
J135	2500469.667	38394131.567	8.41
J136	2500478.067	38394131.901	2.02
J137	2500479.610	38394133.209	

点号	X	Y	边长
J137	2500479.610	38394133.209	1.26
J138	2500480.574	38394134.027	6.92
J139	2500485.716	38394138.655	13.12
J140	2500495.471	38394147.435	0.75
J141	2500496.089	38394147.859	3.39
J142	2500498.883	38394149.779	9.63
J143	2500506.480	38394155.694	6.25
J144	2500511.218	38394159.771	2.32
J145	2500512.982	38394161.284	1.73
J146	2500514.287	38394162.416	6.92
J147	2500519.513	38394166.947	9.05
J148	2500526.462	38394172.741	20.00
J149	2500542.327	38394184.927	20.00
J150	2500558.070	38394197.266	2.91
J151	2500560.707	38394198.506	8.50
J152	2500568.403	38394202.125	0.95
J153	2500569.265	38394202.530	0.26
J1	2500569.501	38394202.641	

S=13526.63 平方米 合20.29亩

2499.97
2499.97

8393.69
8394.26

广东华地自然空间规划研究有限公司

2000国家大地坐标系, 中央子午线114度  
1985年国家高程基准, 等高距1米  
2017年版式  
2025年1月数字化制图

1:4000

制图员: 林楚云  
检查员: 卢加宾  
审核员: 杨 团

# 鹤山市共和镇平汉村排良股份经济合作社征收土地红线图

2499.957-38393.813

单位: m.m<sup>2</sup>

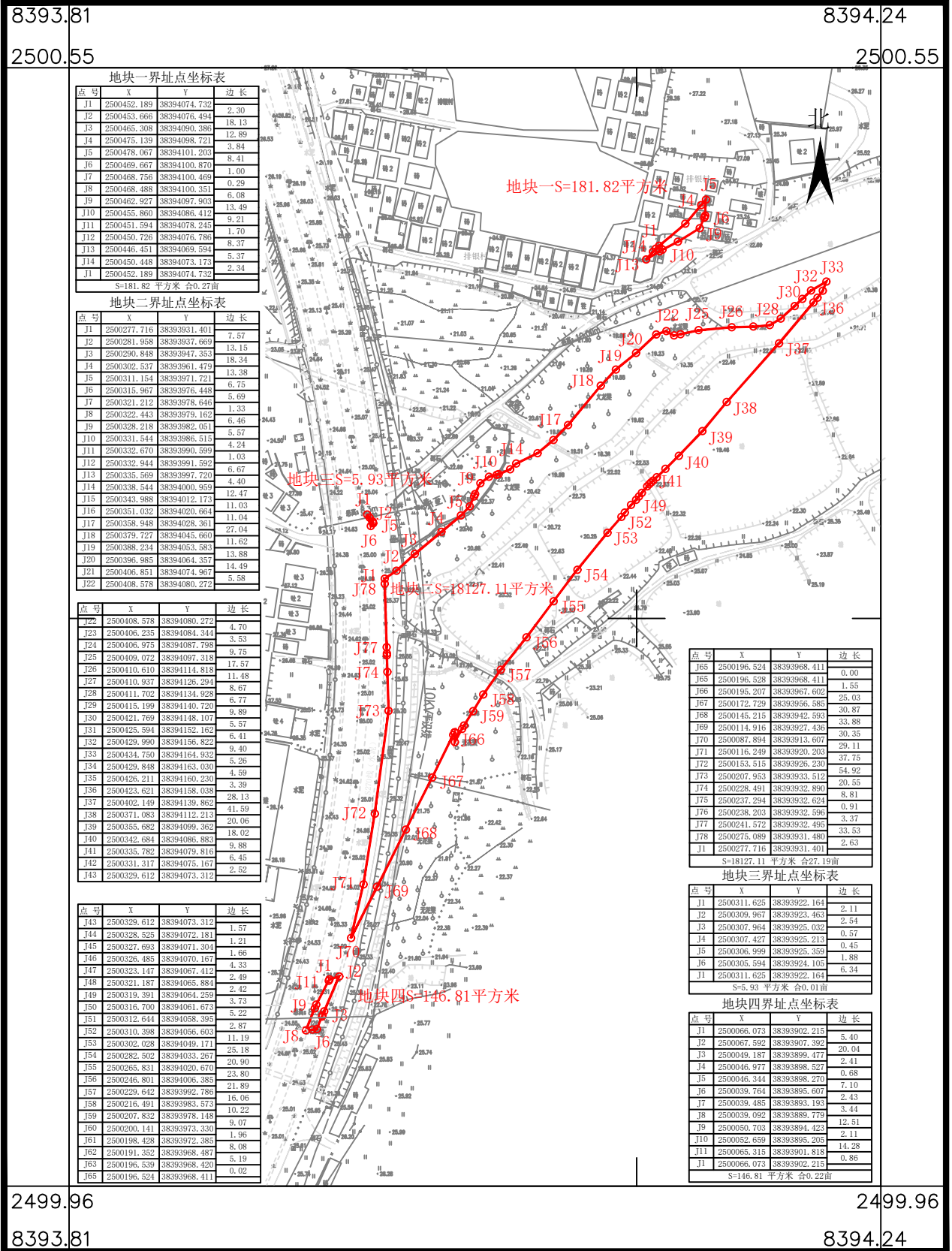

地块一界址点坐标表

点号	X	Y	边长
J1	2500452.189	38394074.732	2.30
J2	2500453.666	38394076.494	18.13
J3	2500465.308	38394090.386	12.89
J4	2500475.139	38394098.721	3.84
J5	2500478.067	38394101.203	8.41
J6	2500469.667	38394100.870	1.00
J7	2500468.756	38394100.469	0.29
J8	2500468.488	38394100.351	6.08
J9	2500462.927	38394097.903	13.49
J10	2500455.860	38394086.412	9.21
J11	2500451.594	38394078.245	1.70
J12	2500450.726	38394076.786	8.37
J13	2500446.451	38394069.594	5.37
J14	2500450.448	38394073.173	2.34
J1	2500452.189	38394074.732	

S=181.82 平方米 合0.27亩

地块二界址点坐标表

点号	X	Y	边长
J1	2500277.716	38393931.401	7.57
J2	2500281.958	38393937.669	13.15
J3	2500290.848	38393947.353	18.34
J4	2500302.537	38393961.479	13.38
J5	2500311.154	38393971.721	6.75
J6	2500315.967	38393976.448	5.69
J7	2500321.212	38393979.646	1.33
J8	2500322.443	38393979.162	6.46
J9	2500328.218	38393982.051	5.57
J10	2500331.544	38393986.515	4.24
J11	2500332.670	38393990.599	1.03
J12	2500332.944	38393991.592	6.67
J13	2500335.569	38393997.720	4.40
J14	2500338.544	38394000.959	12.47
J15	2500343.988	38394012.173	11.03
J16	2500351.032	38394020.664	11.04
J17	2500358.948	38394028.361	27.04
J18	2500379.727	38394045.660	11.62
J19	2500388.234	38394053.583	13.88
J20	2500396.985	38394064.357	14.49
J21	2500406.851	38394074.967	5.58
J22	2500408.578	38394080.272	

S=5.93 平方米 合0.01亩

地块三界址点坐标表

点号	X	Y	边长
J22	2500408.578	38394080.272	4.70
J23	2500406.235	38394084.344	3.53
J24	2500406.975	38394087.798	9.75
J25	2500409.072	38394097.318	11.48
J26	2500410.610	38394114.818	17.57
J27	2500410.937	38394126.294	8.67
J28	2500411.702	38394134.928	6.77
J29	2500415.199	38394140.720	6.77
J30	2500421.769	38394148.107	9.89
J31	2500425.594	38394152.162	5.57
J32	2500429.990	38394156.822	6.41
J33	2500434.750	38394164.932	9.40
J34	2500429.848	38394163.030	5.26
J35	2500426.211	38394160.230	4.59
J36	2500423.621	38394158.038	3.39
J37	2500402.149	38394139.862	28.13
J38	2500371.083	38394112.213	41.59
J39	2500355.682	38394099.362	20.06
J40	2500342.684	38394086.883	18.02
J41	2500335.782	38394079.816	9.88
J42	2500331.317	38394075.167	6.45
J43	2500329.612	38394073.312	2.52

S=18127.11 平方米 合27.19亩

地块四界址点坐标表

点号	X	Y	边长
J43	2500329.612	38394073.312	1.57
J44	2500328.525	38394072.181	1.21
J45	2500327.693	38394071.304	1.66
J46	2500326.485	38394070.167	4.33
J47	2500323.147	38394067.412	2.49
J48	2500321.187	38394065.884	2.42
J49	2500319.391	38394064.259	3.73
J50	2500312.644	38394058.395	5.22
J51	2500310.398	38394056.603	2.87
J52	2500302.028	38394049.171	11.19
J53	2500282.502	38394033.267	25.18
J54	2500265.831	38394020.670	20.90
J55	2500246.801	38394006.385	23.80
J56	2500229.642	38393992.786	21.89
J57	2500216.491	38393983.573	16.06
J58	2500207.832	38393978.148	10.22
J59	2500200.141	38393973.330	9.07
J60	2500198.428	38393972.385	8.08
J61	2500191.352	38393968.487	5.19
J62	2500196.539	38393968.420	0.02
J63	2500196.524	38393968.411	

S=146.81 平方米 合0.22亩

地块三界址点坐标表

点号	X	Y	边长
J65	2500196.524	38393968.411	0.00
J66	2500196.528	38393968.411	1.55
J67	2500195.207	38393967.602	25.03
J68	2500172.729	38393956.585	30.87
J69	2500145.215	38393942.593	33.88
J70	2500114.916	38393927.436	30.35
J71	2500087.894	38393913.607	29.11
J72	2500116.249	38393920.203	37.75
J73	2500153.515	38393926.230	54.92
J74	2500207.953	38393933.512	20.55
J75	2500228.491	38393932.890	8.81
J76	2500237.294	38393932.624	0.91
J77	2500238.203	38393932.596	3.37
J78	2500241.572	38393932.495	33.53
J79	2500275.089	38393931.480	2.63
J80	2500277.716	38393931.401	

S=18127.11 平方米 合27.19亩

地块四界址点坐标表

点号	X	Y	边长
J1	2500311.625	38393922.164	2.11
J2	2500309.967	38393923.463	2.54
J3	2500307.964	38393925.032	0.57
J4	2500307.427	38393925.213	0.45
J5	2500306.999	38393925.359	1.88
J6	2500305.594	38393924.105	6.34
J1	2500311.625	38393922.164	

S=5.93 平方米 合0.01亩

地块四界址点坐标表

点号	X	Y	边长
J1	2500066.073	38393902.215	5.40
J2	2500067.592	38393907.392	20.04
J3	2500049.187	38393899.477	2.41
J4	2500046.977	38393898.527	0.68
J5	2500046.344	38393898.270	7.10
J6	2500039.764	38393895.607	2.43
J7	2500039.485	38393893.193	3.44
J8	2500039.092	38393889.779	12.51
J9	2500050.703	38393894.423	2.11
J10	2500052.659	38393895.205	14.28
J11	2500065.315	38393901.818	0.86
J1	2500066.073	38393902.215	

S=146.81 平方米 合0.22亩

广东华地自然空间规划研究有限公司

2000国家大地坐标系, 中央子午线114度  
1985年国家高程基准, 等高距1米  
2017年版式  
2025年1月数字化制图

1:3000

制图员: 林楚云  
检查员: 卢加宾  
审核员: 杨 团

鹤山市共和镇平汉村排良；平汉村国庆股份经济合作社征收土地红线图

2499.883-38393.798

单位：m.m<sup>2</sup>

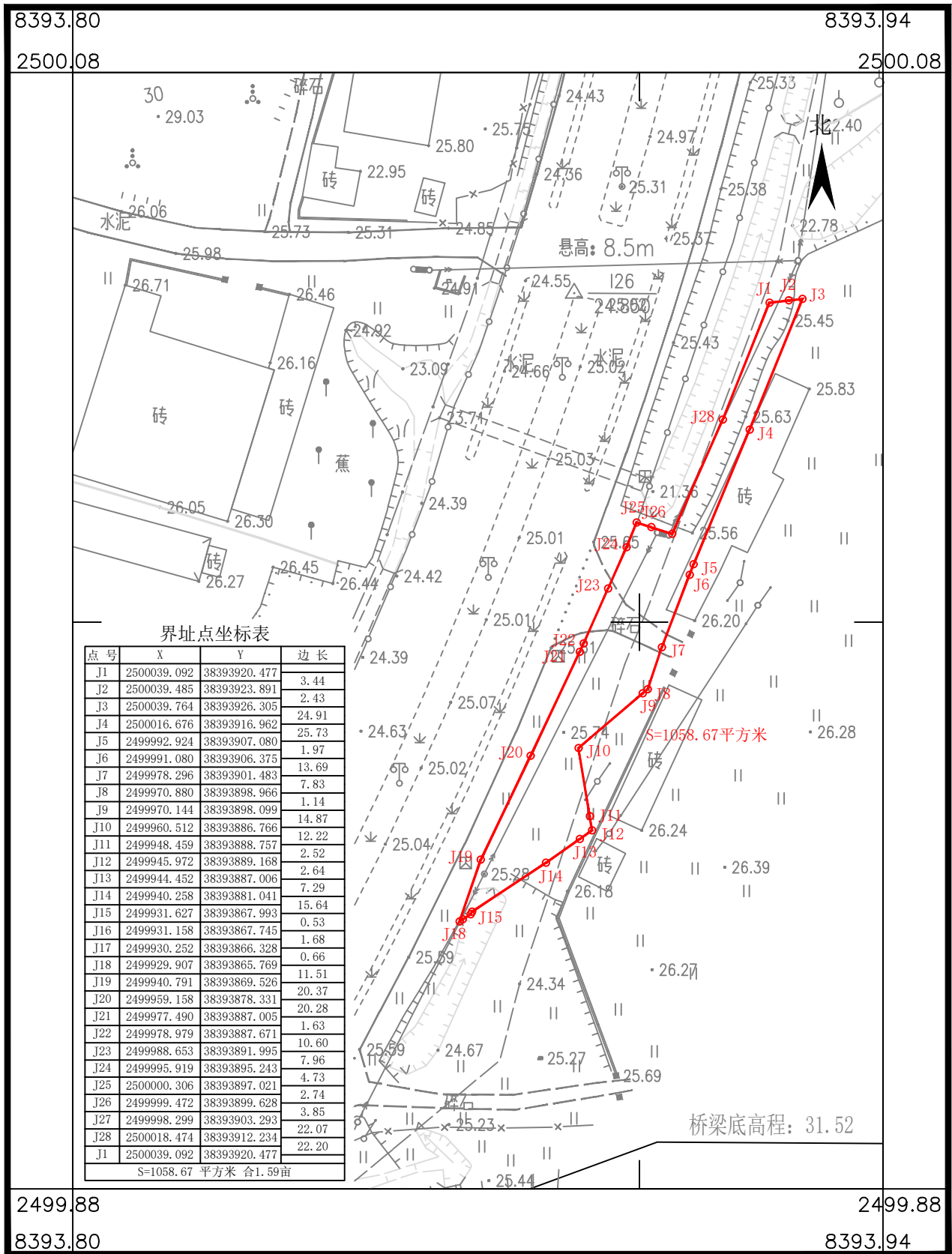

广东华地自然空间规划研究有限公司

2000国家大地坐标系，中央子午线114度  
1985年国家高程基准，等高距1米  
2017年版式  
2025年1月数字化制图

1:1000

制图员：林楚云  
检查员：卢加宾  
审核员：杨 团